

U.S. Postal Service

CERTIFIED MAIL RECEIPT

(Domestic Mail Only; No Insurance Coverage Provided)

0928 4899 6000 029T 0002
7002

--	--

Postage	\$	Postmark Here
Certified Fee		
Return Receipt Fee (Endorsement Required)		
Restricted Delivery Fee (Endorsement Required)		

MR KENT NEWMAN
402 N JACKSON STREET
CRYSTAL SPRINGS MS
39059

for Instructions

Certified Mail[®] Provides:

- A mailing label
- A unique identifier for your mailpiece
- A signature upon delivery
- A record of delivery kept by the Postal Service for two years

Important Reminders:

- Certified Mail may **ONLY** be combined with First-Class Mail or Priority Mail.
- Certified Mail is *not* available for any class of international mail.
- **NO INSURANCE COVERAGE IS PROVIDED** with Certified Mail. For valuables, please consider Insured or Registered Mail.
- For an additional fee, a *Return Receipt* may be requested to provide proof of delivery. To obtain Return Receipt service, please complete and attach a Return Receipt (PS Form 3811) to the article and add applicable postage to cover the fee. Endorse mailpiece "Return Receipt Requested". To receive a fee waiver for a duplicate return receipt, a USPS postmark on your Certified Mail receipt is required.
- For an additional fee, delivery may be restricted to the addressee or addressee's authorized agent. Advise the clerk or mark the mailpiece with the endorsement "*Restricted Delivery*".
- If a postmark on the Certified Mail receipt is desired, please present the article at the post office for postmarking. If a postmark on the Certified Mail receipt is not needed, detach and affix label with postage and mail.

IMPORTANT: Save this receipt and present it when making an inquiry.

SENDER:

- Complete items 1 and/or 2 for additional services.
- Complete items 3, 4a, and 4b.
- Print your name and address on the reverse of this form so that we can return this card to you.
- Attach this form to the front of the mailpiece, or on the back if space does not permit.
- Write "Return Receipt Requested" on the mailpiece below the article number.
- The Return Receipt will show to whom the article was delivered and the date delivered.

Hoy. Waste

I also wish to receive the following services (for an extra fee):

1. Addressee's Address
2. Restricted Delivery

Consult postmaster for fee.

3. Article Addressed to:

MR KENT NEWMAN
 402 N JACKSON STREET 20A
 CRYSTAL SPRINGS MS 518
 39059

4a. Article Number

7000 1670 0009 6843 876

4b. Service Type

- | | |
|--|---|
| <input type="checkbox"/> Registered | <input checked="" type="checkbox"/> Certified |
| <input type="checkbox"/> Express Mail | <input type="checkbox"/> Insured |
| <input checked="" type="checkbox"/> Return Receipt for Merchandise | <input type="checkbox"/> COD |

7. Date of Delivery

9-19-01

5. Received By: (Print Name)

FRANKIE WATTS

6. Signature: (Addressee or Agent)

X Frankie Watts

8. Addressee's Address (Only if requested and fee is paid)

UNITED STATES POSTAL SERVICE



First-Class Mail
Postage & Fees Paid
USPS
Permit No. G-10

• Print your name, address, and ZIP Code in this box •

DEPT. OF ENVIRONMENTAL QUALITY
OFFICE OF POLLUTION CONTROL P.O.
BOX 10385
JACKSON MS 39289-0385

Attn. Gretchen Zmitrovich

NO POSTAGE
NECESSARY
IF MAILED
IN THE
UNITED STATES





FILE COPY

STATE OF MISSISSIPPI
DAVID RONALD MUSGROVE, GOVERNOR
MISSISSIPPI DEPARTMENT OF ENVIRONMENTAL QUALITY
CHARLES H. CHISOLM, EXECUTIVE DIRECTOR

July 18, 2001

CERTIFIED MAIL NO. 7000 1670 0009 6843 8760 RETURN RECEIPT REQUESTED

Mr. Kent Newman
402 N. Jackson Street
Crystal Springs, Mississippi 39059

RE: 402 N. Jackson Street
Crystal Springs, Copiah County, Mississippi

Dear Mr. Newman:

The Uncontrolled Sites Section of the Mississippi Department of Environmental Quality (MDEQ) has completed a review of the attached *Site Remediation Report*, dated April 2001, prepared by Martin & Slagle, GeoEnvironmental Associates, LLC, for the above referenced property. The MDEQ requires no further action at this site at this time.

If cleanup standards change or additional data becomes available for the site, then MDEQ will notify the appropriate parties of the need for any additional investigation(s) or remedial action(s). These actions will be consistent with our need to protect human health, welfare, and/or the environment.

If you have any questions, concerning this matter, please contact Gretchen Zmitrovich at (601) 961-5240.

Sincerely,

A handwritten signature in black ink, appearing to read "Tony Russell".

Tony Russell, Chief
Uncontrolled Sites Section

Enclosure

Kuhiman Electric-402 N. Jackson (Duplex) SNFA_7-18-01 (gz)



FILE COPY

STATE OF MISSISSIPPI
DAVID RONALD MUSGROVE, GOVERNOR
MISSISSIPPI DEPARTMENT OF ENVIRONMENTAL QUALITY
CHARLES H. CHISOLM, EXECUTIVE DIRECTOR

October 11, 2000

Mr. Kent Newman
402 N. Jackson Street
Crystal Springs, Mississippi 39059

RE: soil and wipe sampling

Dear Mr. Newman:

Please find attached the report for the soil and wipe sampling recently conducted at 408/410 Lee Avenue, Crystal Springs, MS. The report includes the following:

1. a map showing the sampling locations, and
2. a table containing the sample results from the analysis conducted by the mobile laboratory, Environmental Chemistry Consulting Services.

Please contact Gretchen Zmitrovich at 601-961-5240 if you have any questions regarding this report.

Sincerely,

A handwritten signature in black ink that reads "Tony Russell".

Tony Russell, Chief
Uncontrolled Sites Section

Enclosure

Kuhlman Electric-408-410 Lee (Duplex) report_10-11-00 (gz)

COPY

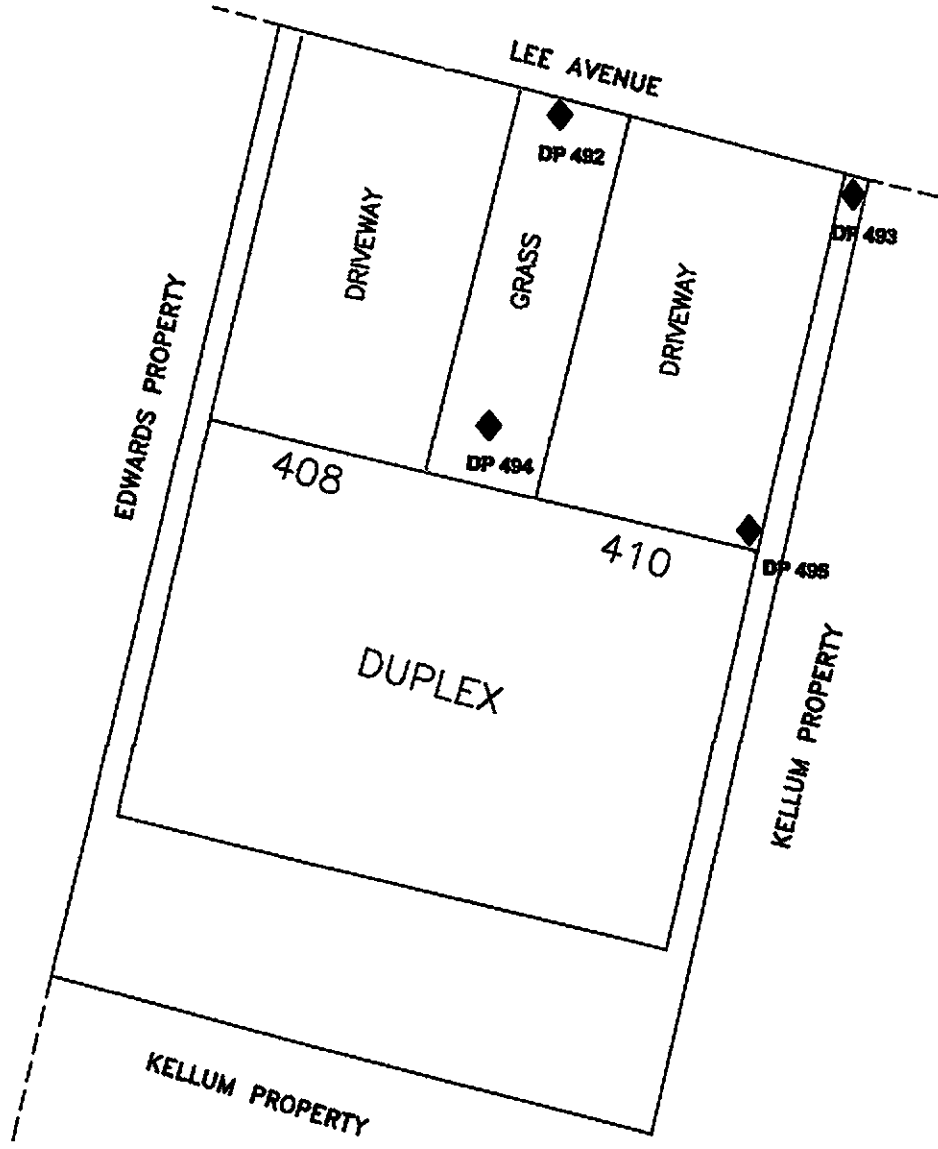

LEGEND
 ◆ SAMPLE POINT
 DP 382 SAMPLE POINT NUMBER



- 1) ALL DISTANCES ARE ESTIMATED
- 2) THIS MAP PREPARED FROM RECORD MAPS
- 3) THIS MAP HAS BEEN PREPARED FOR PRESENTATION PURPOSES ONLY

SAMPLE LOCATIONS FOR NEWMAN DUPLEX 408/410 LEE AVENUE			
SCALE: AS SHOWN	DR MDI	CHK TF	REV BPS
PREPARED BY: OGDEN ENVIRONMENTAL AND ENGINEERING SERVICES			
<small>200 SOUTH OLD STATEVILLE ROAD • HUNTERSVILLE, NC 28078 • 704-875-3370</small>			
PROJ: 073360000	DATE: 09/24/00	SHEET 1 OF 1	

Soil and Wipe Sample Results
 Newman Duplex
 408 / 410 Lee Avenue
 Crystal Springs, Mississippi

SOIL SAMPLES (MG/KG)		DP-492	DP-492	DP-493	DP-494	DP-494	DP-495	DP-495
Target Analyte	Sample #	0.5	4	0.5	4	4	0.5	4
	Depth (ft)	427	428	429	430	432	433	434
	Lab #	4.6	<0.10	0.84	<0.10	<0.10	0.47	<0.10
PCB as 1260								
	Collection Date	8/24/00	8/24/00	8/24/00	8/24/00	8/24/00	8/24/00	8/24/00
	Collection Time	14:34	14:35	15:23	15:24	15:30	15:34	15:35
	Injection Date	8/24/00	8/24/00	8/25/00	8/25/00	8/25/00	8/25/00	8/24/00

WIPE SAMPLES (TOTAL UG)		DW-1	DW-2	DW-3	DW-4
Target Analyte	Sample #	755	756	757	758
	Depth	<0.50	<0.50	<0.50	<0.50
	Lab #				
PCB as 1260					
	Collection Date	8/30/00	8/30/00	8/30/00	8/30/00
	Collection Time	15:08	15:10	15:11	15:13
	Injection Date	8/31/00	8/31/00	8/31/00	8/31/00

Notes:

- LOCATION:
- DW1: Western front door, 408 Lee Ave.
 - DW2: Eastern front door, 410 Lee Ave.
 - DW3: Wire mesh foveaset on front entrance porch.
 - DW4: Air conditioning unit, 410 Lee Ave.